

STONELEIGH & ASHOW *News*



SEPTEMBER 2018



"The Heart of Stoneleigh" Defibrillator

In the phone box on The Green

Coordinator

David Ellwood 07785 284482

Text if no reply

Trained Volunteers

John Churchley	07885 496795
Becki Coombe	07841 378404
Laura Elliot	07738 222969
David Ellwood	07785 284482
Richard Hancox	07770 826310
Ian Huston	07974 237331
Sharron McEldowney	07760 101775
Claire Neale	07557 675842
Lisa Reay	07716 416320
Martin Smith	07958 955629
Mary Taylor	07890 535506

Remember: Always ring 999 first!



Film Night

**Friday 14th September
in Stoneleigh Village Hall
6.45 pm for 7 pm**

This month we are showing:

'The Greatest Showman'

Hugh Jackman leads an all-star cast in this bold and original musical filled with infectious showstopping performances. Inspired by the story of P.T. Barnum (*Jackman*) and celebrating the birth of show business, the film follows the visionary who rose from nothing to create a mesmerising spectacle.

This inspirational film also stars Zac Efron, Michelle Williams, Rebecca Ferguson and Zendaya.

Make yourself feel at home, bring your own wine, cushions or a comfy chair. Coffee and pastry in the interval.

Tickets: £3.00, to cover refreshments and room hire.
To reserve a place please call Jane: 01926 858315

Cover Image

Bart the Springer Spaniel usurps ducks at the village fayre to cool down.

HS2 UPDATE

Margaret Wallis, on behalf of the Stoneleigh Action Group (against HS2)

There has been widespread press coverage of issues relating to HS2 throughout the summer - including escalating costs, high salaries for staff, delays in compensation and ineffective liaison with local communities - with increasing calls for the project to be abandoned. Despite much-publicised problems throughout the existing rail network, there are no signs that this will happen.

Locally, ground investigations around New Kingswood Farm began during late August/early September. HS2 Ltd has released a video describing how and why these investigations are being undertaken all along the route. One can only speculate what will be found and the extent to which adjustments mean further delays. To see this video, search online for 'HS2 ground investigations video'.

It is important to note the significant ground investigation contracts for 6 months additional work have been placed by the Main Works Contractor (MWC) (Balfour Beatty Vinci) in our sector, i.e. Long Itchington to Lichfield (N1 and N2), and similar work required to the south of us at Old Oak Common by other consortia. This work is required to clarify and augment the very limited data handed over by HS2 Ltd to date. HS2 Ltd has so far spent over £4 billion of public money with little to show in this area apart from newt ponds near Dalehouse Lane and the Stoneleigh Park Bat House (recently completed!) The effect is that without accurate data it is impossible to design, plan and cost work with any accuracy. Inevitably this will lead to delays in the contract negotiations and notice to proceed by the Minister and the Department for Transport at least until mid-2019.

Meanwhile, the Early Works Contractor (Laing O'Rourke/Murphy) will be continuing minor works in our area for the next 6 months e.g. B4115 site work and Kingswood Farm. The Parish Council has requested updates from the MWC and the enabling works contractor (LM) on 18 October, when it is hoped that there will be some planning data to share and members will be allowed some input. The Parish Council has been grateful to Colin Hooper of Stoneleigh Park, who has provided updates on HS2 Ltd activities in the Park and associated land.

The local press reported that planning permission has been given for substantial roadworks designed to improve the junction with Stoneleigh Road and the A46. Warwickshire Council Council highways staff will be updating the September PC meeting on A46 progress and timetables. Quite how work associated with HS2 and the proposed transfer of the Rugby market from Stoneleigh Park to the same area can be co-ordinated remains to be seen.

Stoneleigh History Society

Sheila Woolf

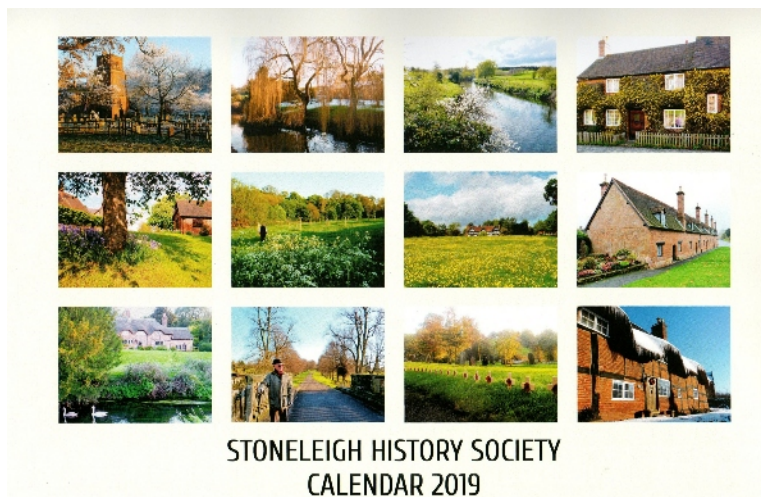

Have you bought your 2019 Stoneleigh calendar yet? These were on sale at the Duck Race and we thank all those who purchased one then. Our calendar consists entirely of the beautiful photographs taken by the late Will Blagburn, who spent so much time documenting our village. Will was for a time at Myton Hospice, and all our profits are going, in his memory, directly to the hospice.

You can still buy calendars from Jimmy at the Club (thanks, Jimmy!) or from me. They cost £7.50 each and would make a great Christmas present for friends and relatives who perhaps no longer live in the village. They even come in their own card envelope for posting, at no extra charge!

The next meeting of the History Society will take place at the Village Hall on Tuesday 25 September at 7.30pm. Shirley Ball will share more reminiscences of life at Stoneleigh School. If you were a pupil, from whatever era, please come along and take a trip down memory lane with us!

Sheila Woolf
02476 418759
shewoolf@hotmail.co.uk

WI Report

Liz Sykes

024 7641 8301



Celebrations continue: both for the County federation and for Stoneleigh. We are both celebrating centenaries this year.

The 'big day out' for the Warwickshire Federation took place on July 30th, when 884 members of the WIs in Warwickshire descended on Lincoln. There was an 'honorary' member that day: Dennis, Marion's husband, who is also her carer. He was the only male in the host of females on that day. There were 18 coaches departing from various venues in Warwickshire to arrive at Lincoln Cathedral during the morning.



We were greeted by the Lord Mayor of Lincoln and the Dean of the cathedral. There was a reception for all our members and then a welcome from the Dean. During the afternoon there was a 'fly past' by a Red Arrow. All really enjoyed this special day, that was sponsored by Johnsons coaches.

Our Stoneleigh celebrations continued with a visit to a vineyard in Herefordshire. This is a small business run by a couple. They produce about 2000 bottles a year and they have won awards for one of their wines. Our coach driver was brilliant, as we had to go down some very narrow lanes to get there.

On arrival we were greeted by the owners with coffee and gorgeous cakes in a lovely old barn. We then had a tour of the vineyard, when the different varieties of grapes were explained, followed by a wine tasting.

Lunch followed, again in the barn, and we then walked around their lovely garden that is open all year for the National Garden Scheme.

Another lovely day out, with glorious weather. Of course we ended up in the shop buying the wine!

Our next outing is to the Royal Mint in Llantrisant. This is on September 12th and costs £28. There are still some places on the coach, so please contact me if you would like to go (024 7641 8301 / liz.sykes.t21@btinternet.com).

The lunch club is on the 4th. Please contact me if you are interested, as it does help with catering.

Coffee morning is September 18th at the club at 10:30am. Everyone is welcome - come and have a chat and meet your neighbours - it's only a pound! We look forward to seeing you there.

The next WI meeting is on September 3rd at the village hall at 7:30pm. The speaker will be Heather Wilson and her talk is entitled 'Mad hats and Maharajas'. This sounds interesting - why not come along for a good evening with refreshments?

A FOND FAREWELL

Pennee the Post

Greetings to the good people of Stoneleigh and surrounding area. As you all will have noticed, I do not deliver your post any more. At the beginning of February I had a trial period working in the callers office in the afternoon. I literally took to it like a duck to water, and have been working there ever since. Although the position was temporary to start with, it became permanent at the beginning of July.

The decision to leave Stoneleigh was not an easy one to make, especially as I consider many of you to be friends more than customers. I'm on my fortieth year working for The Post Office/Royal Mail, and can honestly say that the eleven years I delivered the post in Stoneleigh have been the most enjoyable of those years. Unfortunately the job was getting more difficult, and I'm not getting any younger! With the best will in the world I couldn't physically continue to do the job. Needless to say when the opportunity for a less physical job came along, I grabbed it with both hands!

At some point in the near future Rob will take over the job of delivering your post, and I'm sure you will all make him as welcome as you made me feel.

Best Wishes to you all for the future

STONELEIGH MALE VOICE CHOIR

Margaret Wallis



Summer Serenade

An enthusiastic crowd gathered in the walled garden at Stoneleigh Abbey on a sweltering hot 8th July to enjoy another wonderful Summer Serenade by the Stoneleigh Male Voice Choir, together with their guests, the Ukuholics Ukelele Band from Coventry, directed by Tony Scanlon.

The Choir, accompanied by their musical director, Alan Biddle, and conductor, Judy Hadfield, treated the audience to a range of old favourites as well as some new numbers, ending with a rousing 'When the Saints go marching in'. The Ukuholics raised the nostalgia stakes with a set in each half of the programme, including 'Leaning on a Lamp post' and 'San Francisco Bay Blues'. The two choirs joined led the audience to a grand finale featuring 'Land of Hope and Glory'.

Given the weather, sartorial challenges were much in evidence ranging from men in summer suits to t-shirts and flip flops, and women in varying degrees of 'floatiness' and skin exposure! Overheard comments included "This is SO civilised" to "It is SO hot!"

A highly successful raffle was held and a cheque for £2000 was presented to Tony Britton of the Pam Britton Trust for Dementia, thus continuing the Choir's long tradition of charitable fund-raising. Cheques for £250 each were also given to Stoneleigh Abbey for their Defibrillator Fund and, through the Ukuholics, to The Enterprise Club, Coventry.

Huge thanks to Phil Jones and his colleagues, the Ukuholics, Keith Walker and his team at the bar and the servers, all those who supplied, prepared and purchased food, donors/purchasers of tickets, the Outdoor Staging Company who ran the sound system and Kenilworth Lions for their support in setting up the arena. Last but not least, thanks to the Abbey residents who were prepared to host the event for a second year. Here's to the third! We are all so fortunate to be able to enjoy the results of so much hard work by Phil Jones and his colleagues.

N.B. If you would like to sing in a fun choir (enthusiasm required more than musical ability) or you would like the Choir to sing for you at one of your own fund raising events, please contact the Chairman, Phil Jones, on 01926 853511 or email at kathrynjones@hotmail.co.uk

The Choir's next concert is for Water Aid, at St. John's Church, Kenilworth on Saturday 13 October 2018 when it will be joined by Warwick Youth Choir and a guest solo violinist. Tickets from Phil Jones.

Duck Race and Village Fayre

Thanks to everyone who worked so hard to make this year's Village Fayre such a success.

Feedback from all exhibitors was very positive, and everyone had a great day out. The photo shows volunteers emptying the ducks of water after their swim before packing away until next year: Just one of the many tasks you never knew went on behind the scenes to make everything run smoothly.

The winning ducks were:

1st: Number **1132**

2nd: Number **324**

3rd: Number **1439**

The winning celebrity duck was..... **Emily!**



Parking in Stoneleigh

Richard Hancox

Dear Resident,

Over the years we have talked about "Considerate Parking" and have put a lot of effort to try to get all residents thinking about where they are parking and the impact it might have on other neighbours and friends.

Whilst appreciating that the number of cars that require parking in the village has increased, we do feel that many residents and visitors perhaps don't think of the impact they are causing when they park where they do.

We all like to park as close to home as we can, but there are certain areas that it really isn't safe to park. Parking close or on road junctions is probably the most dangerous place to park: not only are you preventing certain pedestrian users (wheelchairs, pushchairs etc.) from using the footway, you are also forcing them to cross roads where it just isn't suitable and visibility is not so good.

Before we injure one of our own, can we please ask that you all consider where you park and find somewhere safer and less disruptive.

Parking on the footway is a contradiction of the Highway Code. Although it is not feasible for the police to act on every vehicle that contravenes this they will take action where such parking causes safety concerns. We do not want to get the police involved but in the interest of safety and protecting residents if you continue to park in an inconsiderate and dangerous location then we will.

The final step is to get double yellow lines painted around most junctions. This is the last thing we want to do so please think as you walk away from your vehicle: is it parked in a safe place, and not likely to place others in danger?

Just two examples of poor parking are the junctions of Hall Close and Stoneleigh Close with the Birmingham Road. The route from most of the village to the Village Hall and the playing facilities means that children have to cross both these roads on their route to and from the facility. Crossing any road is dangerous but where you are crossing between or behind a parked car makes it extremely dangerous - please don't!

Stoneleigh and Ashow Parish Council

Stoneleigh Village Club
Est. 1856

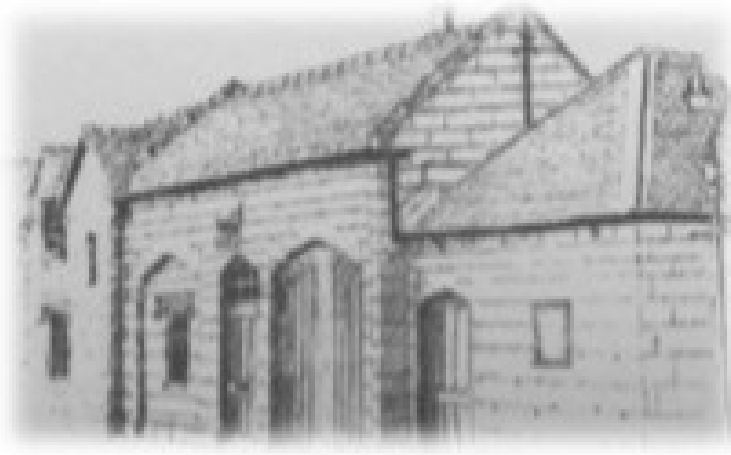

2018/19 'pull out and keep' guide

www.stoneleighvillageclub.co.uk

Welcome from your Committee,

A very warm welcome, foremost to our members, but also to our neighbours in the wider community and visiting patrons.

We hope that you will use this guide as a reminder of general information throughout the year, as well as sharing it with others that may enjoy visiting our Village Club.

Of course, keep an eye out for Stoneleigh's fantastic monthly community magazine where event dates and times are published!

GET INVOLVED IN THE RUNNING OF OUR VILLAGE CLUB!

1. Share your 'grins and grumbles' – with your pledge to further support your ideas – through our secure box inside SVC
2. Chat to a committee member at 'Committee-d': any 2nd Friday of the month between the hours of 5pm and 6.30pm
3. Email and request to visit a committee meeting as an observer 7.30pm - 8pm any 2nd Monday of the month. **(This is a great way to see if you would like to play a part on the Committee, or, to meet all members at the same time!)**
4. Drop us an email at: info@stoneleighvillageclub.co.uk

Don't forget to post your photos and updates through the year!

[www.facebook.com /stoneleighvillageclub](https://www.facebook.com/stoneleighvillageclub)

Regular Events:

Mondays	8.30pm	Darts Team
Tuesdays	8.30pm	Pool Team
3 rd Tuesday	10.30-12pm	Coffee Morning
Alternate Wednesdays	7.00pm	Bingo
Opposite Wednesdays	7.30pm	Knit and Natter
Thursdays	7.30pm	Crib, Dominoes
		check first (play 'away' too)
Fortnightly Thursdays	8.00pm	Book Club alternated with
		Ladies Night
Last Friday	7.30pm	Entertainment & Street Food

British Summer Time:

Saturdays	9.00am	Run Club
2 nd Saturday	10.30am	Walk Club: Slow and Steady
4 th Saturday	10.30am	Walk Club: Approx. 10km

Annual Events:

AUGUST	Duck Race
SEPTEMBER	Marrow Competition Judging
OCTOBER	Halloween
DECEMBER	Children's Christmas Party, Christmas Celebrations
DEC/JAN	New Year's Eve
EASTER	Easter Egg Hunt and Bonnet Parade
JUNE	Annual General Meeting

*In addition to the showing of many live sporting
events throughout the year!*

Stoneleigh Village Club is available to hire!

SVC is a **Members' Club** and remains open to members during normal opening hours. However, it may be exclusively hired for events outside of our normal opening hours. Full details are available in the Club, or by emailing info@stoneleighvillageclub.co.uk.

Exclusive hire charges start at £40 for any part of the first four hours, then £10 per hour/part hour. Additional charges apply for staff, drinks, catering, extended licensing hours and cleaning. Please ask for a quote.

Stoneleigh Village Club offers a warm and friendly atmosphere with free and secure WiFi operated by *The Cloud*. It is fully accessible to wheelchairs, both inside and within our homely back garden.

Please be mindful of our neighbours and community by parking respectfully and only on *one side* of the road, ensuring emergency vehicles can pass.

Smoking is only permitted at the rear of the property and drinks must only be consumed inside, or within our garden , to comply with our licensing regulations.

Request booking information: info@stoneleighvillageclub.co.uk

Thank You

Jayne, Alastair and Kate Brooks would like to express their gratitude to everyone for the many cards, letters and messages sent to them at the time of David's death.

Everyone who came to David's Service helped to make it a joyous occasion and made a dark time so very much lighter. Thank you.

J.L. Huthwaite



Property Maintenance Ltd

jayhuthwaite1@sky.com

07921 842217

024 7501 1320

Roofing - Guttering - Lead - Chimney Repairs - Painting - Decorating -
Wallpapering - Coving - Skirting Boards - Architraves - Doors
Laminate Flooring - Floor - Wall Tiling - Garden Maintenance - Patios -
Landscaping - Wall Repairs & Pointing... And More

-FOR A FREE NO OBLIGATIONS QUOTE-

-CALL TODAY-

-NO JOB TOO SMALL-

PARISH COUNCIL NOTES

Hannah Watts

Meetings

The next Ordinary Parish Council meeting will be held on Thursday, September 13th at 7pm in Stoneleigh Village Hall. We will be joined by Nicola van der Hoven and Adrian Hart of Warwickshire County Council who will give an update on the A46 Stoneleigh junction. Members of the public are invited to attend all meetings. The agenda, including upcoming planning applications, can be found on the Parish Council website, at <http://stoneleighshowparishcouncil.btck.co.uk/CouncilMeetings>

A note from the new Parish Clerk

As the new Parish Clerk, I am very excited about getting to know the residents and issues for the Parish. I started work on July 9th and feel very fortunate to be working with the Councillors in such a beautiful parish. This is my first role as a Parish Clerk and I am very much still finding my feet, but I am looking forward to the challenge of the role and being able to contribute to the community.

Hannah Watts, Clerk to the Parish Council

Update from the last Parish Meeting

On July 12th, the Parish Council were pleased to welcome Barry Butterworth, Development Manager at Wasps Arena Coventry, who spoke about the plans for the Wasps RFC to develop land at the Old Leamingtonians site in Leamington Spa for a training centre. As well as providing training facilities for the Wasps, the new site will run a number of community programmes for the young and old.

Mr Butterworth talked about the plan to build sports and leisure facilities in such a way that will fit into the local environment. The plan will include additional parking facilities, an artificial pitch and facilities appropriate to a professional rugby club.

Full details of Mr Butterworth's presentation can be found in the July meeting minutes, available on the parish council website:

<http://stoneleighshowparishcouncil.btck.co.uk/CouncilMeetings/Minutes2018>

HS2 Update from Cllr Bianco

We have requested an update from HS2 and the contractors to be available for our September meeting. However, they have postponed until October as they have not made sufficient progress since our June meeting and our responses in July have yet to be fully answered.

Please see the HS2 report in this issue of the magazine for more details.

Traffic Survey

The full traffic survey for Stoneleigh, giving three preferred options, is finally available for viewing on the Stoneleigh and Ashow Parish Council Website: stoneleighshowparishcouncil.btck.co.uk/VillageMatters/Highways

The cheapest option is to close Birmingham Road to all traffic. If this is something you feel strongly about, or would like to know more, details of next Parish Council meeting are on the previous page.

Figure 6. Option 2 Alignment

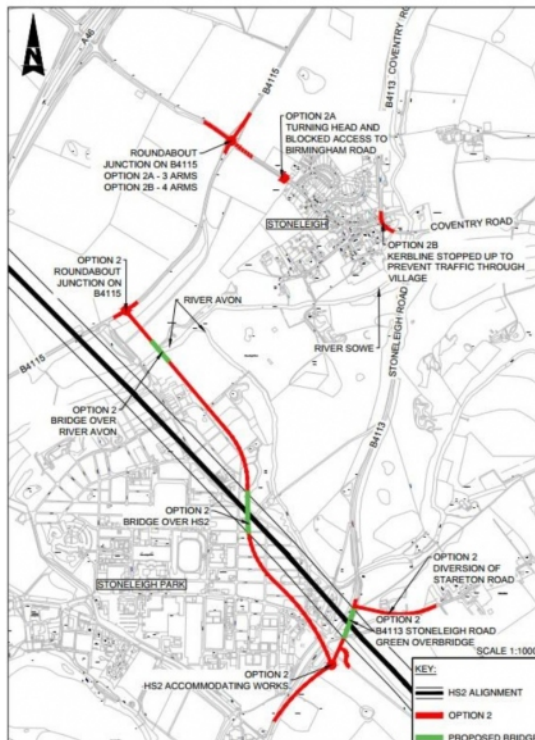

Stoneleigh Village Club

Becki Coombe



**WELCOME TO THE START OF 'REGULAR NORMALITY'
(AND THE SCHOOLS BEING BACK)!**



As another Duck Race has successfully passed, glasses must be raised and thanks passed onto our Social Events Team. You may wish to consider joining them. Some are pictured here as winners of our 'best Facebook picture' of the month competition. They had the tiresome task of quality assuring our very own Mixologist's cocktails for the event; **Tracy Brown** please claim your free drink!

STONELEIGH VILLAGE CLUB - UPCOMING EVENTS

- | | |
|---|--|
| Saturday 8 th Sept. | 8.45pm UEFA National League: England v Spain
(Half time food TBC) |
| Thursday 13 th Sept. | 7.45pm Book Club
<i>* Why Mummy Drinks by Gill Sims *</i> |
| Friday 21 st Sept. | 7.30pm Pudding Club
Puddings presented 7.30pm, tasting 8pm |
| Friday 28 th Sept. | 10am -2pm Worlds Biggest Coffee Morning
in aid of Macmillan Support |
| 28 th - 30 th Sept. | Ryder Cup action on the big screen |
| Sunday 30 th Sept. | 7:30pm Prize Marrow Weighing Evening |

☺ STONELEIGH VILLAGE CLUB WELCOMES NON-MEMBERS TO SIGN IN FOR £1 PER VISIT ☺

Fancy a free drink? It's easy, post a photo to Facebook and include StoneleighVillageClub in your post so it gets re-posted onto our page: www.facebook.com/stoneleighvillageclub. The winner will be posted in the magazine, so... get snapping & posting!!

Please do send your updates and news to us via our Facebook page above, or email us at stoneleigh.villageclub@gmail.com.

Stoneleigh Walk Club

Becki Coombe

<<< CUT OUT AND KEEP >>>

Stoneleigh Village Club to Kings Head at Cubbington - Loop

Flat, 14km (3 hours + pub stop)



Monthly Guided Walks:

Every 2nd Saturday: Max 10km. Flat Ramble: Meet and return to SVC, 10.30am start.
Every 4th Saturday: Approx 5km. Slow and Steady: Suitable for those un-used to walking.

Church Notices

Rev. Nikki Moon

Creationtide

As I write this, the heatwave is ongoing, I'm still a few days from my annual summer holiday and yet my attention is turned towards the autumn. The autumn is probably one of my favourite times of the year as the leaves turn from lush green into an array of different yellows, oranges and browns. The evenings become chilly, the mornings misty and we all start to turn our attention towards the approaching Christmas season as the supermarkets begin to stock the shelves with Christmas cards, trees and gifts.

But perhaps this year we might resist moving ahead too quickly and instead linger in the beauty of autumn, noticing the various fruits the hedgerows produce; both for us to make pies, crumbles, homemade wine and gin and also for the birds to stock up with before winter sets in.

This time of year is called 'Creationtide' in the church calendar. A time to give thanks for the harvest and for all the fruits of the season as well as for those who work the land and produce our food. This year we will be celebrating harvest on 23rd September at 11am in Stoneleigh Church and on 30th September at 9:30am in Ashow Church. Do come along for our family friendly services and help us to celebrate this beautiful time of the year. Please bring with you something you have grown yourself or something you have found in the hedgerows that speaks of autumn. Please do also bring non-perishable and fresh produce for us to auction and donate to those in need.

If you are not able to join us then I hope you will take some time to enjoy the autumn; run or walk through fallen leaves noticing the sounds or stop to admire the beauty of shiny conkers, ripe blackberries and colourful foliage. Perhaps also take a moment to think about those who have worked so hard and in the difficult weather conditions to ensure we will all have food on the table this coming winter.

God Bless

Rev. Nikki

Church Notices

Revd. Nikki Moon

Baby and Toddler group

The Baby and Toddler group is an informal opportunity to meet other mums, dads, grandparents and carers.

The Leigh Chapel in Stoneleigh Church is carpeted, has comfortable seating and a small children's play area. We would like to invite families and carers to a drop in between 10am and 12 noon on Tuesday 18th September.

Refreshments will be on offer along with a warm welcome.

Please do pass the date and time on to others in the village and in the surrounding area who might be interested. If you would like more information or this date is not convenient and you would like to be included in future drop-ins please do get in touch.

Revd Nikki Email: njmoon@outlook.com Tel: 07891 012660

Harvest Festival 23rd September @11am Stoneleigh Church

This is an opportunity to join us in celebration for the gifts of creation and the fruits of the harvest.

This service will be informal and family friendly and lasts about 30 minutes. Please bring with you any of the following:

- A flower, vegetable or plant that you have grown yourself.
- Something from the hedgerows that speaks of autumn (conkers, blackberries, acorns etc.)
- Fresh produce to be auctioned at the harvest lunch
- Some produce to donate to the local foodbank (tins, packet food, toiletries etc.)

The service will be followed by harvest lunch at 1pm in the village hall.

During the lunch there will be an opportunity to see the recording of Songs Of Praise made in Stoneleigh some 30 years ago. Tickets available from June Burr (02476 227726) and Jane Taylor (01926 858315).

Heritage Open Day & Stride and Ride – September 8th 10am to 4pm

St Mary the Virgin Church, Stoneleigh will be open throughout the Heritage Open Day season but on Saturday 8th September we will have refreshments being served throughout the day.

Churchyard maintenance - Help required.

Our churchyard is maintained and made beautiful for all who visit by a committed team of volunteers. Do you have the time and energy to help the churchyard team?

Autumn grounds working party Saturday 27th October from 9.30am until noon. Refreshments will be served. All welcome.

Regular and occasional help required for:

Mowing, strimming, pruning, path edging and cutting back.

If you are able to help please contact Clive Watson: 024 7641 1658

Why is Stoneleigh church locked?

It is with sadness that we have temporarily kept Stoneleigh Church locked during the summer. The church was vandalised and items stolen from the kitchen, bell tower and Leigh Chapel and it was for the health and safety of all that we took the decision to lock the church.

Unfortunately, we are one of many churches that have been targeted in similar ways in the past few weeks. It is our hope that we will reopen for a few hours each day from September and fully reopen once we have secured funding for an update to our security systems which were disabled during the break in.

As a church community, we are reliant on you, our neighbours, to be eyes and ears for anything suspicious. We please ask that if you see or hear anything suspicious you alert the police and one of the churchwardens.

If you would like access to the church please do contact a churchwarden who will try and arrange for the church to be open.

Many thanks for your understanding
Revd. Nikki.

Stoneleigh Community Orchard Update

Pete Freeman



This year's harvest looks set to be a large one, and preparations are underway for this.

More news will follow in next month's Stoneleigh and Ashow News: Watch this space...

This month's edition of ***Stoneleigh and Ashow News*** was compiled by Mike and Bernice Evans, who would like to thank all contributors.

It was printed by Warwick Print.

The online colour version can be viewed at www.stoneleighvillage.org.uk

The September 2018 edition will be compiled by

Lisa Reay

lisareay@btinternet.com

Craigton, Vicarage Road, Stoneleigh CV8 3DJ

Copy deadline: 18th September 2018

All copy should be sent to the editor's email address (above).

Advertisements at £40 (full page A5) or £20 (half page) accepted at the editor's discretion, subject to S&A News policy.



THE UNITED BENEFICE OF
THE ASSUMPTION OF OUR LADY,
ASHOW
and
ST MARY THE VIRGIN, STONELEIGH



SERVICES FOR SEPTEMBER 2018

Sunday 2 nd	10.00 am United Holy Communion at Stoneleigh
Sunday 9 th	9.30 am Holy Communion at Ashow
Wednesday 12 th	10.30 am Midweek Communion Service at Stoneleigh
Sunday 16 th	9.30 am Holy Communion at Ashow 11.00 am Fellowship Holy Communion at Stoneleigh
Sunday 23 rd	9.30 am Village service at Ashow 11.00 am HARVEST FESTIVAL at Stoneleigh
Sunday 29 th	9.30 am HARVEST FESTIVAL at Ashow 11.00 am Holy Communion at Stoneleigh

From the Registers at Stoneleigh – Weddings

Saturday 28 th July:	Jamie John Love to Sarah Elizabeth Hancox
Saturday 4 th August:	Samual David Hobbins to Shannon Brooks
Saturday 11 th August:	James George Cooper to Jemma Anne Foskett Ireland

Funerals

Thursday 21 st June:	Handel Rex – Thanksgiving service
Friday 22 nd June:	Margaret Ann Sturman - Memorial service
Tuesday 31 st July:	David Henry Brooks – Thanksgiving service
Wednesday 1 st August:	Winifred Louch – Interment of remains
Thursday 9 th August:	Stella Elizabeth Pountney – Interment of remains

Contacts:

Reverend Nikki Moon. 07891 012660. Email njmoon@outlook.com

Ashow Churchwarden:	Vacancy
Deputy Warden:	Peter Shrimpton 01926 859404
Stoneleigh Churchwardens:	June Burr 02476 227726 Gordon Gatward 02476 690746
Deputy Warden:	Richard Ashley 01926 427729

For any other matter please contact the Parish Administrator,
Jackie Cubitt, 02476 415506 email: admin@stoneleighchurch.co.uk
website: www.stoneleighchurch.co.uk

Office hours: Wednesday 9.00am to 12.00pm; Thursdays 9.00am to 1.00pm